

1

2

3

4

A

A

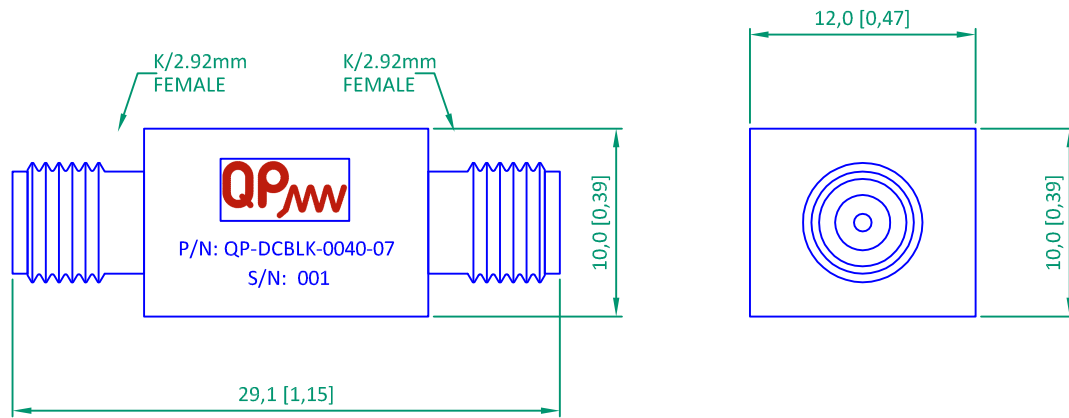

B

B

**ALL DIMENSIONS SHOWN
ARE IN mm [inch]**

C

C

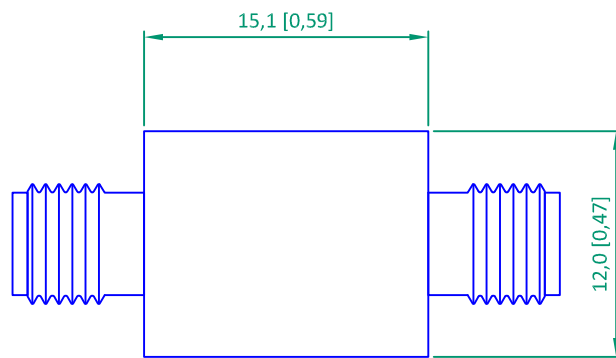

D

D

ELECTRICAL SPECIFICATIONS:

FREQUENCY RANGE: 20 kHz - 40 GHz
 INSERTION LOSS: 1.2 dB MAX.
 VSWR: 1.5:1 MAX.
 DC VOLTAGE: 16 V MAX.

E

E

ENVIRONMENTAL RATINGS

- TEMPERATURE: -40°C TO +85°C (OPERATING)
 -55°C TO +125°C (STORAGE)
 - HUMIDITY: MIL-STD-202G, METHOD 103B COND. B
 - SHOCK: MIL-STD-202G, METHOD 213B COND. B
 - VIBRATION: MIL-STD-202G, METHOD 204D COND. B
 - ALTITUDE: MIL-STD-202G, METHOD 105C COND. B
 - TEMP. SHOCK: MIL-STD-202G, METHOD 107G COND. A



NOTE: The above specifications are subject to change or revision. Specifications are at 25°C unless stated otherwise

F

F

	QP microWAVE CÓLQUIDE 6 28231 LAS ROZAS MADRID, SPAIN	APPROVALS	DATE	SIGNED	DESCRIPTION: DC BLOCK 20 kHz - 40 GHz	REV.:	SHEET:
		DRAW	14/08/18	AGI	CODE: QP-DCBLK-0040-07	001	1 OF 1
		CHECKED	14/08/18	BME			
		APPROVED	14/08/18	BME			

1

2

3

4