

1

2

3

4

A

A

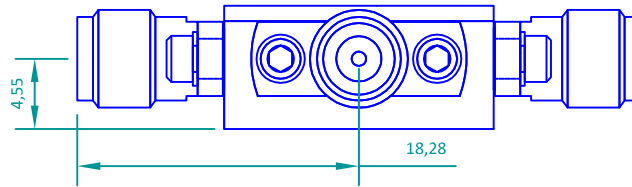

B

B

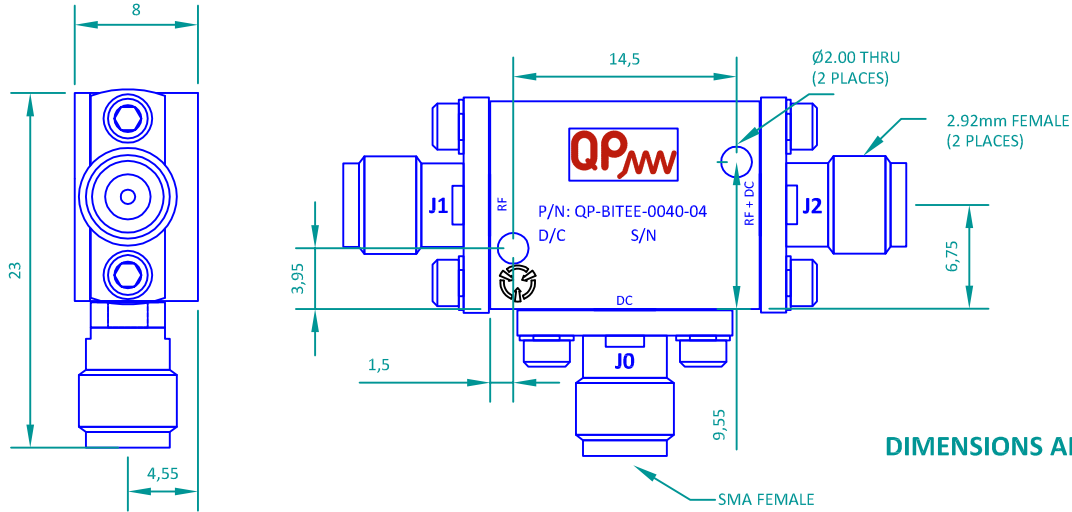

DIMENSIONS APPEAR IN mm

C

C

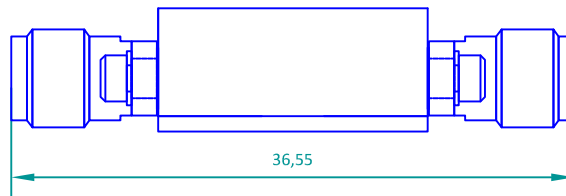

ELECTRICAL SPECIFICATIONS:

FREQUENCY RANGE:	500 MHz - 40 GHz
INSERTION LOSS:	1.5 dB TYP. 1.8 dB MAX.
VSWR :	1.6:1 TYP. 2:1 MAX.
DC VOLTAGE:	50 V MAX.
DC CURRENT:	1000 mA MAX.

D

D

ENVIRONMENTAL RATINGS

- TEMPERATURE:	-40°C TO +85°C (OPERATING) -55°C TO +125°C (STORAGE)
- HUMIDITY:	MIL-STD-202G, METHOD 103B COND. B
- SHOCK:	MIL-STD-202G, METHOD 213B COND. B
- VIBRATION:	MIL-STD-202G, METHOD 204D COND. B
- ALTITUDE:	MIL-STD-202G, METHOD 105C COND. B
- TEMP. SHOCK:	MIL-STD-202G, METHOD 107G COND. A

E

E



NOTE: The above specifications are subject to change or revision. Specifications are at 25°C unless stated otherwise.

F

F

QP microWAVE
CÓLQUIDE 6
28231 LAS ROZAS
MADRID, SPAIN

APPROVALS	DATE	SIGNED	DESCRIPTION: BIAS TEE 500 MHz - 40 GHz	REV.:	SHEET:
DRAW	06/05/16	BME	QP-BITEE-0040-04	000	1 OF 1
CHECKED	06/05/16	JAV			
APPROVED	06/05/16	JAV			

1

2

3

4